

County Hall (Dun Laoghaire-Rathdown)

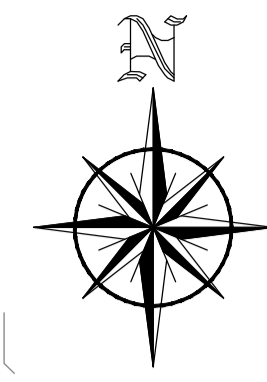

LEGEND

- PROPOSED FOUL SEWER:
- PROPOSED SURFACE WATER SEWER:
- PROPOSED FOUL AND STORM INSPECTION CHAMBERS:
- PROPOSED ACCESS JUNCTIONS:
- PIPE NUMBER, DIAMETER AND GRADE:
- MANHOLE NUMBER, COVER AND INVERT LEVEL:
- EXISTING FOUL AND STORM SEWER:
- PROPOSED STORAGE ATTENUATION SYSTEM:
- PROPOSED ROAD GULLY:
- PROPOSED ACO DRAIN:
- PROPOSED PERFORATED LAND DRAIN:
- SITE BOUNDARY EXTENTS:

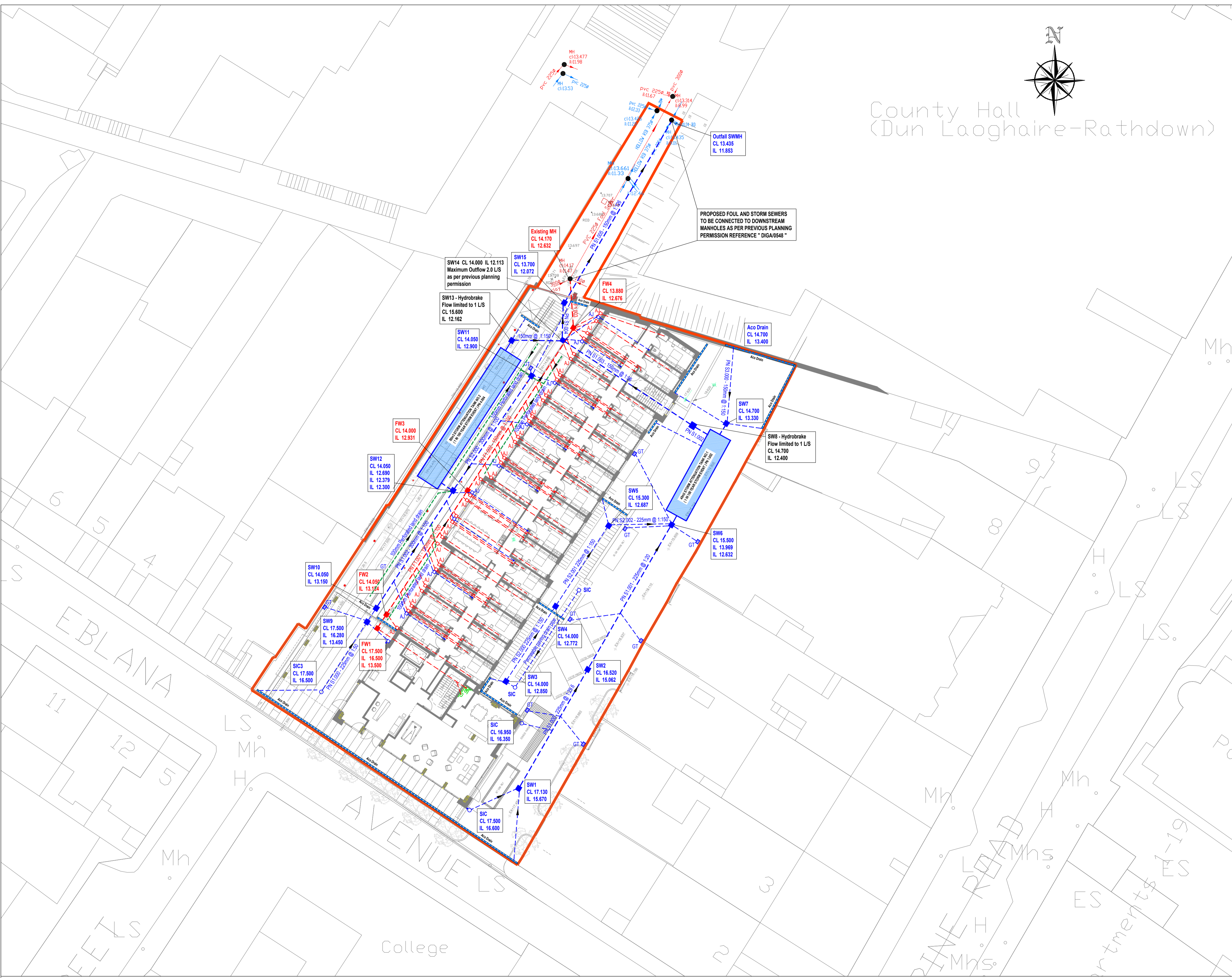

- ### NOTES
- All works will be carried out in accordance with the requirements of IW Codes of Practice for Wastewater.
 - The total impermeable runoff from the proposed roof and paved areas amounts to 2640m². The runoff will discharge to 2 no. storage attenuation tanks. Tank no. 1 is sized at 40m³ capacity to take 992m² area runoff and Tank no. 2 is sized at 80m³ capacity to take 1648m² area runoff. Both tanks are designed for the 100 year storm event inclusive of 20% allowance for climate change.
 - Outflow from each attenuation tank will be limited to 1 L/S. Therefore the maximum outflow from the development will be limited to 2 L/S.
 - Finished Floor Leves to be finalised with Architect.
 - All manholes in grassed areas to have 200mm wide x 100mm deep concrete plinth / kerb cast to their perimeter to ensure they are not overgrown. Concrete to be grade C20/C25.
 - External face of all proposed manhole chambers to be minimum 0.5 metre from the kerb line and the external face of the sewers to be minimum 1.0 metre from the kerb line in accordance with Section 1.23 of the Irish Water Code of Practice for Wastewater Infrastructure.
 - New manholes constructed over existing Irish Water public sewer to be constructed to Irish Water Standards STD-WW-09, STD-WW-10, AND STD-WW-11
 - Concrete surround in accordance with Irish Water standard detail STD-WW-07 and STD-WW-08 to be provided to all sewers where minimum cover (900mm) is not achieved - note the absolute minimum depth of cover above the external crown of the pipe shall be 750mm.
 - All foul sewer pipe materials shall be of either concrete, thermosetting structured walled pipes or unplasticised pvc in accordance with Section 3.13 of the Irish Water Code of Practice for Wastewater Infrastructure.
 - Setting out and co-ordination of service pop ups and drainage locations to be confirmed and set out by M&E and Architect.
 - CS Consulting are not responsible for either foul and storm water drainage above ground level.
 - The contractor to confirm all invert levels to existing drainage and confirm with the engineer prior to commencement of any drainage works on site.
 - All drainage works to be constructed in strict accordance with Part H of the Building Regulations, Irish Water and Dun Laoghaire Rathdown County Council Specifications / Requirements.
 - The contractor shall air test pipes upon completion in accordance with part H of the Building Regulations.
 - The Contractor shall conduct a CCTV survey of all drains upon completion of the works to ensure the integrity of the drains.
 - Building materials (blocks) should not be stockpiled above pipes or watermain.
 - The contractor is responsible for the protection of all pipes (existing and proposed) during construction. Given the tight nature of the site, the construction management plan should make specific reference to the protection measures (concrete encasement and steel plates etc.) to be afforded to the pipes to protect them from overloading due to delivery trucks or other heavy plants.
 - The contractor should make reference to the previously completed utility survey and site investigation reports for the location of known services on site. However, the contractor is responsible for completing his own survey and due diligence prior to undertaking any excavations on site.
 - Soil Vent substacks and rainwater locations to be confirmed by Architect / M&E.
 - Where proposed sewers in public roads have depth of cover of less than 1.2 metres, it is proposed to protect same with 150mm concrete in accordance with the requirements set out in Section 4.7 of the Irish Water Code of Practice for Wastewater Infrastructure.

Planning Drawing
Not for Construction
This drawing has been issued for information purposes only and must not be used for construction under any circumstances

**APPROVED BY
IRISH WATER**

NOTES

- For setting out refer to Architect's drawings.
- This drawing to be read in conjunction with all other Architectural and Engineering drawings and all other relevant drawings and Specifications.
- DO NOT SCALE THIS DRAWING. Use figured dimensions only.
- No part of this document may be reproduced or transmitted in any form or stored in any retrieval system of any nature without the written permission as copyright holder except as agreed for use on the project for which the document was originally issued.
- Ordnance Survey Ireland Licence Number EN 0074018

Rev. No.	Date	REVISION NOTE	Drn. By	Chkd. By
A	2019-01-09	Revision to Sewer Network	DF	GL
B	2019-04-02	Layout Revision	DF	GL

Client	Bartra Property (Eblana) Limited
Project	The Old School House, Eblana Avenue Dun Laoghaire, County Dublin
Title	Foul and Storm Sewer Drainage layout
Drn. by	DF
Chkd. by	GL
Apprd. by	RF
Scale	1:250
Date	Nov 2018
Draw. No.	B098-001
Revision	B

CS Consulting Group

DUBLIN | LONDON | LIMERICK

Head Office
19-22 Dame Street, Dublin 2.
T: +353 (0)1 5480863 F: +353 (0)1 9011355
e: info@csconsulting.ie
w: www.csconsulting.ie

Quality: I.S. EN ISO 9001:2008
Environment: I.S. EN ISO 14001:2004
Energy: I.S. EN ISO 50001:2011
Health & Safety: OHSAS 18001:2007