

80mm Tobermore Hydropave block paving
 50mm depth of 6-2mm Grit bedding layer to BS EN 7533-13: 2009
 Upper Sub-base, 100mm depth 5-20mm Clean stone coarse graded aggregate to BS EN 13242: 2002. Depth subject to CBR tests.
 Lower Sub-base, 210mm depth 10-60mm clean stone coarse graded aggregate to BS EN 13242: 2002. Depth subject to CBR tests.
 CBR Tests of Sub grade to be confirmed prior to construction

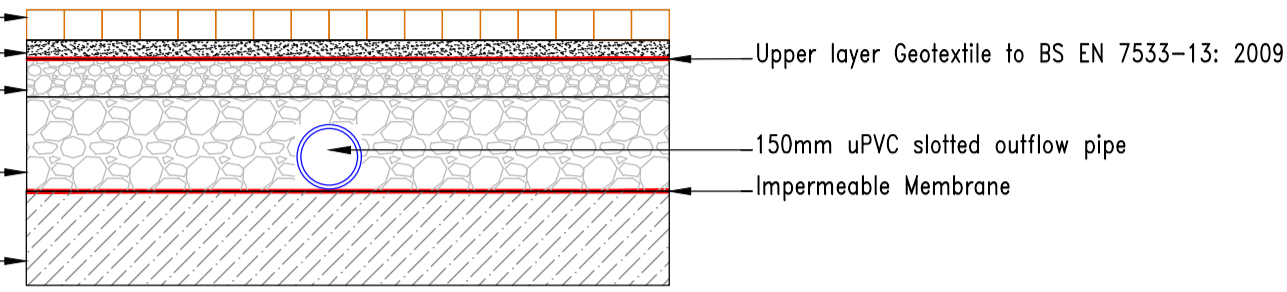

DETAIL A. System C - Car / Van Parking.
Attenuated Permeable Paving
 Scale 1:20

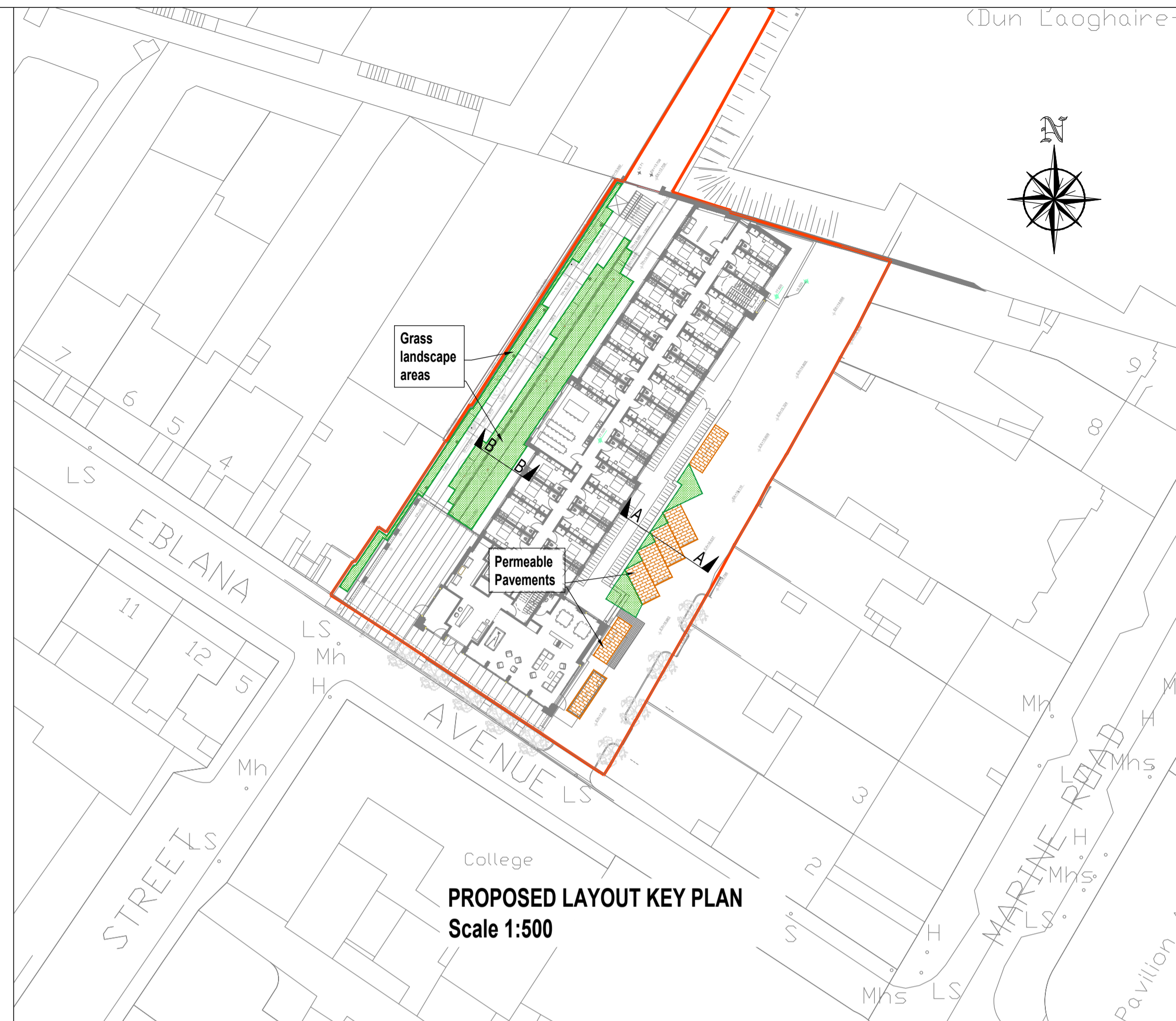

PROPOSED LAYOUT KEY PLAN
 Scale 1:500

LEGEND	
Car / Van Permeable Paving Areas	
Grassed landscaped Areas	
Outline of Site Development	

- NOTES**
- Areas of permeable paving as follows:
 A. Car / Van Parking Area = 87 m2.
 Total Areas = 87 m2.
 - Permeable Paving to meet the requirements of BS EN 7533-3: 2005, BS EN 7533-13: 2009 and BS EN 13242: 2002.
 - Flood Study Report Soil Classification maps for the Eblana site suggests Class 4 or an infiltration value of 0.47. Therefore the site has high runoff potential or low infiltration capacity. Subject to infiltration tests, site potentially unsuitable for infiltration and therefore attenuation of permeable paving is proposed with outflow connected to the proposed storm drainage network.
 - Design and specifications for permeable pavements outlined in this drawing provisional only and subject to completion of soil infiltration and CBR tests outlined in points 5 and 6 below.
 - CBR Tests to be carried out in accordance with BS 1377: Part 9: 1990 prior to final design and installation works.
 - Soil Infiltration tests to be carried out in accordance with BRE 365 prior to final design and installation works.
 - Proposed permeable pavement in this site will provide 87m2 of interception storage for first flush 5mm rainfall events. Refer to drawing B098 - 011 Rev A - for catchment areas interception storage details.

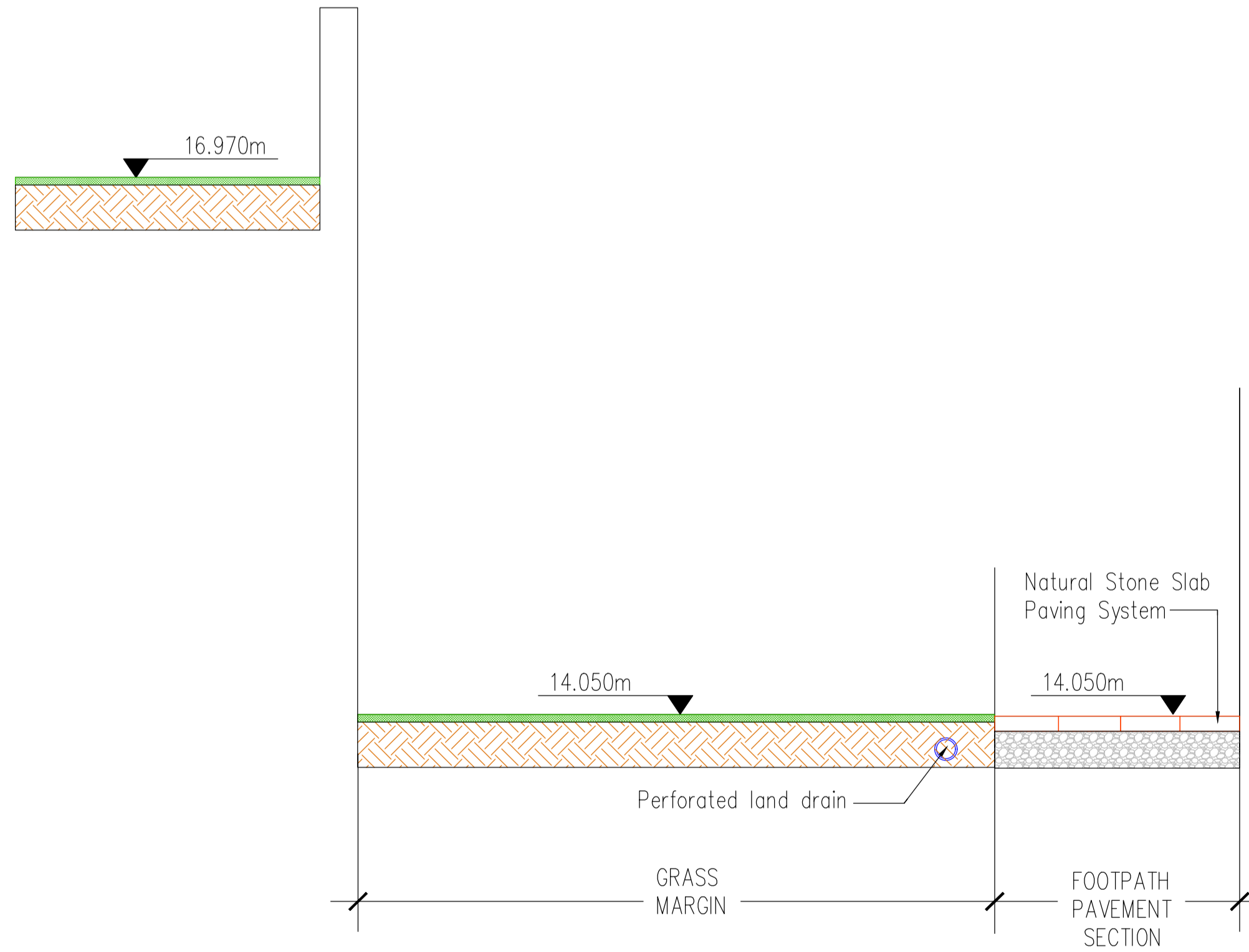

PAVEMENT SECTION B - B
 Scale 1:25

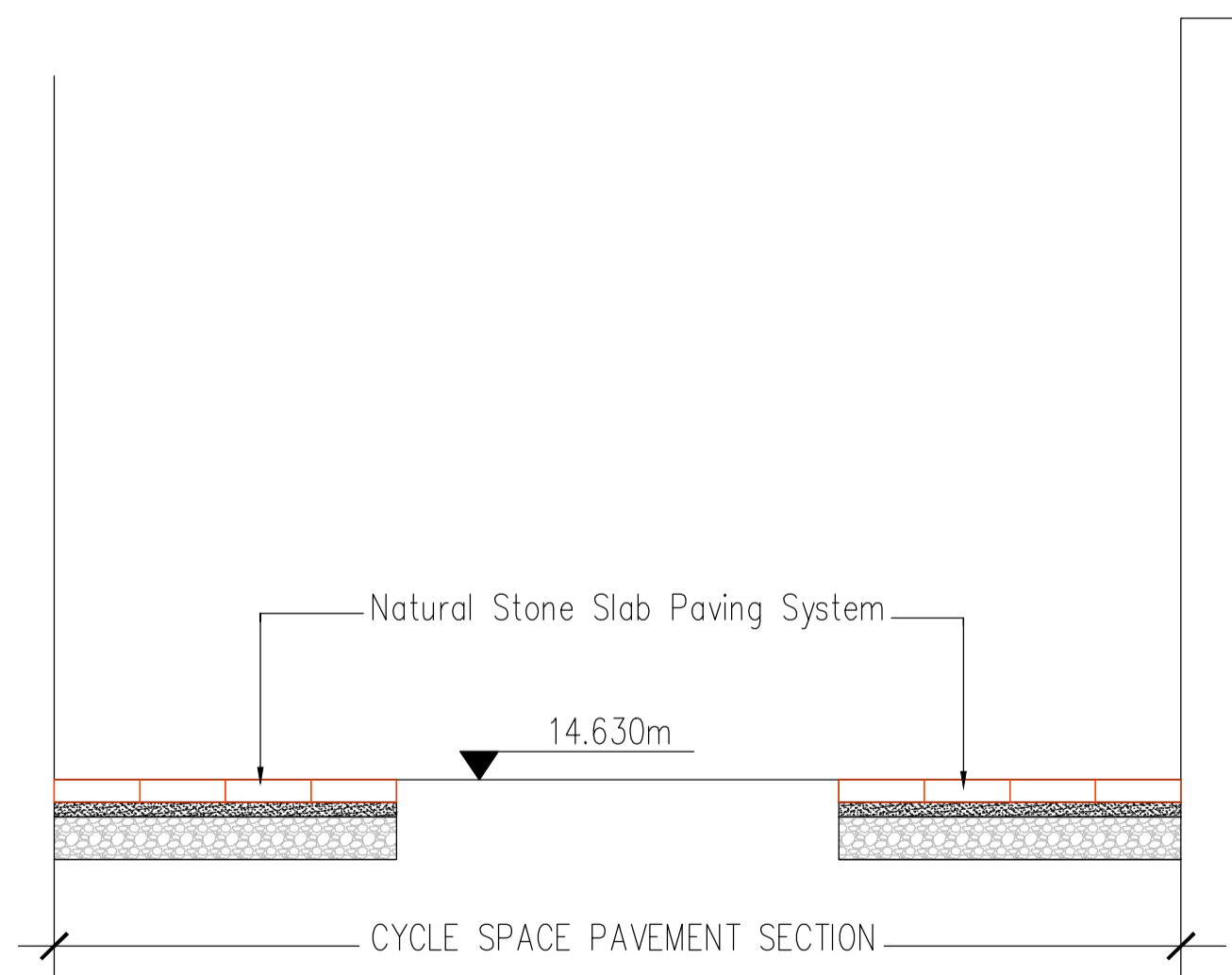

CYCLE SPACE PAVEMENT SECTION

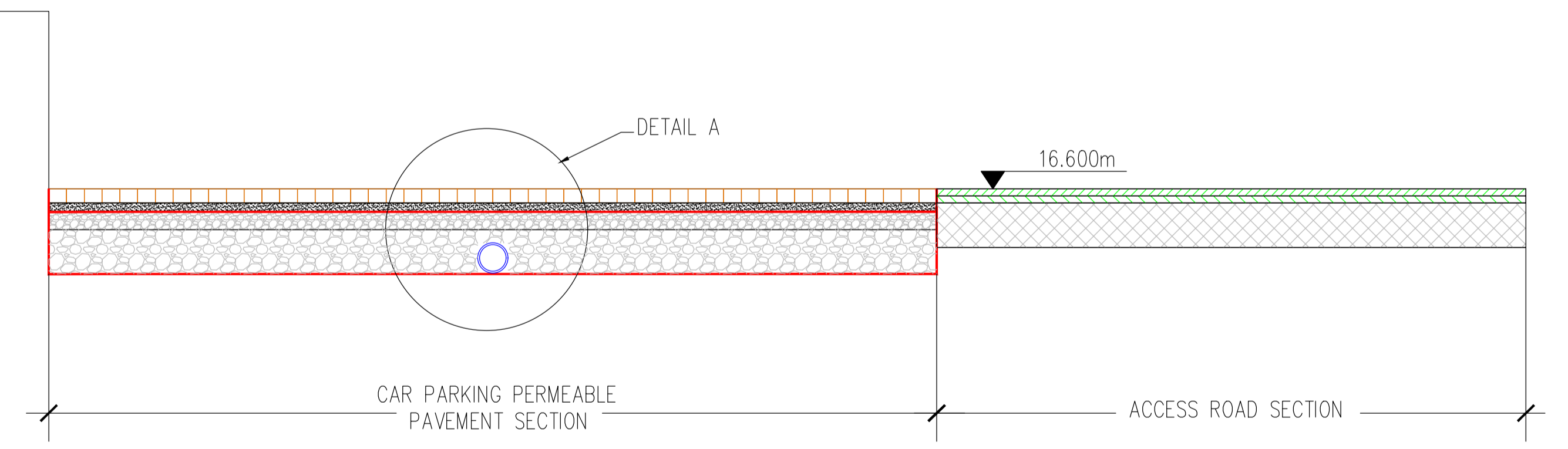

PAVEMENT SECTION A - A
 Scale 1:25

Planning Drawing
 Not for Construction
 This drawing has been issued for information purposes only and must not be used for construction under any circumstances

NOTES

- For setting out refer to Architect's drawings.
- This drawing to be read in conjunction with all other Architectural and Engineering drawings and all other relevant drawings and Specifications.
- DO NOT SCALE THIS DRAWING. Use figured dimensions only.
- No part of this document may be reproduced or transmitted in any form or stored in any retrieval system of any nature without the written permission as copyright holder except as agreed for use on the project for which the document was originally issued.
- Ordnance Survey Ireland Licence Number EN 0074018

Rev. No.	Date	REVISION NOTE	Drn. By	Chkd. By
A	2019-04-02	Layout Revision	DF	GL

Client	Bartra Property (Eblana) Limited		
Project	The Old School House, Eblana Avenue Dun Laoghaire, County Dublin		
Title	Permeable Pavement Layout and Construction Details		
Drn. by	Chkd. by	Apprd. by	Dwg. No.
DF	GL	RF	B098-010
Date	Scale	As Shown	Revision
Jan 2019			A

CS Consulting Group
 DUBLIN | LONDON | LIMERICK

Head Office
 19-22 Dame Street, Dublin 2.
 T: +353 (0)1 5480863 F: +353 (0)1 9011355
 e: info@csconsulting.ie
 w: www.csconsulting.ie

Quality Environment I.S. EN ISO 9001:2008
 Energy I.S. EN ISO 14001:2004
 Health & Safety OHSAS 18001:2007