

LEGEND

- 1. EXISTING PUBLIC WATERMAINS ---
- 2. PROPOSED WATERMAINS —
- 3. PROPOSED SLUICE VALVE SV
- 4. PROPOSED AIR VALVE A
- 5. PROPOSED HYDRANT H
- 6. PROPOSED BULK WATER METER BWM
- 7. NON RETURN VALVE NRV
- 8. SITE BOUNDARY —

NOTES

1. All works will be carried out in accordance with the requirements of Irish Water Codes of Practice for Water.
2. Location of all existing water supply utilities to be verified before construction works.
3. All chambers in grassed areas to have 200mm wide x 100mm deep concrete plinth/kerb cast to their perimeter to ensure they are not overgrown. Concrete to be grade C20/25.
4. External face of all proposed manhole chambers to be minimum 0.5 metre from kerblines and the external face of watermains to be minimum 1.0 metre from the kerblines.
5. Concrete surround in accordance with Irish Water standard detail STD-WW-07 and STD-WW-08 to be provided to all watermains where minimum cover (900mm) is not achieved - note the absolute minimum depth of cover above the external crown of the pipe shall be 750mm.
6. Boundary box to be installed as shown in accordance with Irish Water Code of Practice for water infrastructure.
7. Thrust blocks to watermain to be as per Irish Water standard detail STD-W-28.
8. The location of all valves and hydrants shall be designed in accordance with section 3.15.4 of the Irish Water Code of practice.
9. Note the Fire Safety Certificate has not been completed yet, but as part of this development, it is confirmed that hydrants shall not be located any more than 46m from any part of the development.
10. All new watermain materials shall be in accordance with Section 3.9 of the Irish Water Code of Practice for Water Infrastructure.
11. All pipework, valves, chambers, network arrangements and all associated watermain works to be in accordance with Irish Water Codes of Practice and Standard Details.
12. Air Pressure tests to all works to be taken in charge to Irish Water Codes of Practice Section 4.10.
13. Manifold Chambers will be used to provide a communal box for the duplex apartments and that each dwelling unit will have its own supply pipe and meter and stop valve. All meters in the manifold shall be tagged to indicate which property is supplied and any unused outlets will be blanked off in accordance with section 3.15.3 of the Irish Water Code of Practice.
14. The proposed 100mm watermains will be located a minimum of 300mm from the wastewater infrastructure in accordance with section 3.5.18 of the Code of Practice for Waste Water Infrastructure.

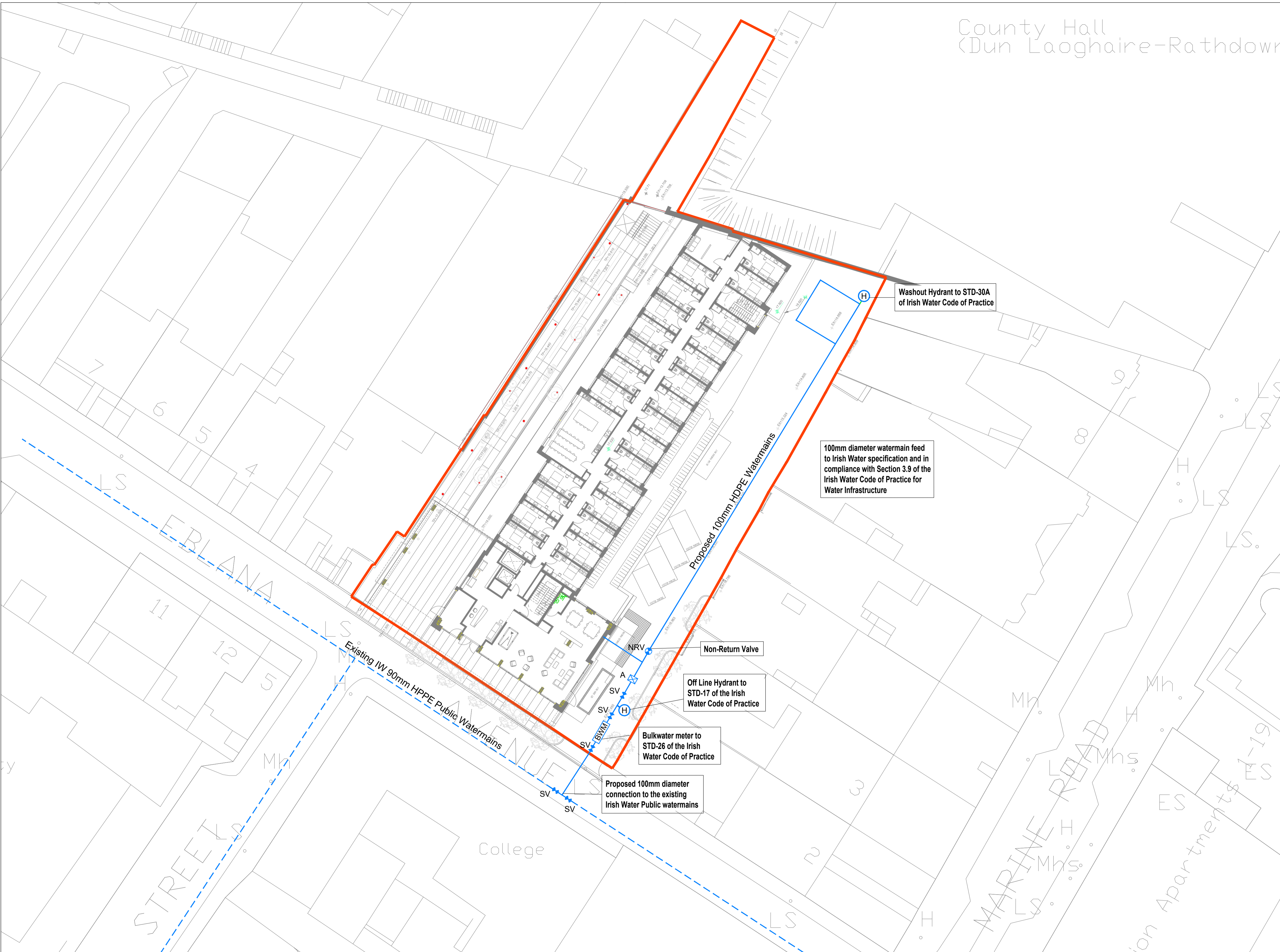

Planning Drawing
Not for Construction
This drawing has been issued for information purposes only and must not be used for construction under any circumstances

APPROVED BY
IRISH WATER

NOTES

1. For setting out refer to Architect's drawings.
2. This drawing to be read in conjunction with all other Architectural and Engineering drawings and all other relevant drawings and Specifications.
3. DO NOT SCALE THIS DRAWING. Use figured dimensions only.
4. No part of this document may be reproduced or transmitted in any form or stored in any retrieval system of any nature without the written permission as copyright holder except as agreed for use on the project for which the document was originally issued.
5. Ordnance Survey Ireland Licence Number EN 0074018

Rev. No.	Date	REVISION NOTE	Dm. By	Chkd. By
A	2019-04-02	Layout Revision		

Client	Bartra Property (Eblana) Limited		
Project	The Old School House, Eblana Avenue Dun Laoghaire, County Dublin		
Title	Watermains Layout Plan		
Dm. By	Chkd. by	Apprd. by	Dwg. No.
DF	GL	RF	B098-008
Date	Scale	Revision	
Nov 2018	1:250	A	

CS Consulting Group
DUBLIN | LONDON | LIMERICK

Head Office
19-22 Dame Street, Dublin 2.
T: +353 (0)1 5480863 F: +353 (0)1 9011355
e: info@csconsulting.ie
w: www.csconsulting.ie
